



## **Camarada *Tango Obsession***

### **Technical & Hospitality Rider**

*Purchaser please initial in the blank spaces below:*

#### **Backline:**

Piano - Steinway or Yamaha grand pianos preferred; tuned on day of performance plus adjustable artist bench.

\*If the venue does not have a grand piano, please let us know.

Initials \_\_\_\_\_

#### **Additional Backline Needed:**

*Camarada is based in San Diego. When the band is flying to a venue the purchaser will also need to provide the following backline:*

**Double Bass**

-Double Bass-Size: 3/4 carved top, with bridge-height adjusters

-String Length: about 41" (from nut to bridge)

-String Type: Orchestral tuning

Initials \_\_\_\_\_

**Music Stands**

-4 music stands

Initials \_\_\_\_\_

#### **Sound: (to be provided by venue)**

-1 talking microphone on microphone stand, stage left

-Electricity: extension cord, power strip if applicable

-All necessary cables

-PA System

Initials \_\_\_\_\_

Purchaser agrees to provide Sound Support as detailed above.

**Point of Contact for Contract Purposes:**

***Marian Liebowitz: Booking Agent***

***Marian@marianliebowitz.com***

619-988-0751

**Point of Contact for Advancing Purposes:**

**Beth Ross Buckley: Artistic Director**

**bethrossbuckley@gmail.com**

**619-917-2444**

**Stage Plot**

CAMARADA  
Tango Obsession

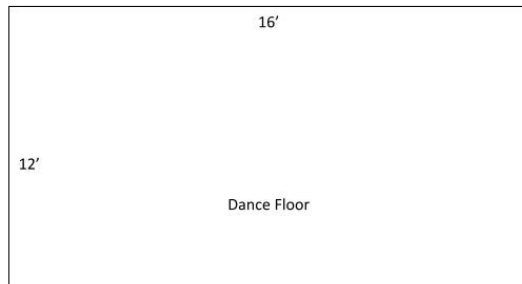

Please provide  
1 microphone  
for speaking to  
the audience



Camarada: Beth Ross Buckley, Artistic Director  
619.917.2444  
[bethrossbuckley@gmail.com](mailto:bethrossbuckley@gmail.com)

Agent: MLAM  
Marian Liebowitz  
619.988.0751  
[marian@marianliebowitz.com](mailto:marian@marianliebowitz.com)

Initials

Purchaser agrees to provide Stage Setup as detailed above.

**Dressing Rooms**

- At least 2 (two) dressing rooms with restrooms available. Dressing rooms must be able to be locked and secured when unoccupied.
- At least 1 (one) ironing board, iron and/or steamer.
- At least one room should have mirrors and appropriate lighting.

Initials

Purchaser agrees to provide Dressing Rooms as detailed above.

**Green Room**

- Please have available before sound check 12 water bottles (2 per person), preferably at room temperature (not chilled).
- Tea and coffee before sound check.
- 6 Face towels
- No alcohol

Initials \_\_\_\_\_

Purchaser agrees to provide Green Room as detailed above.

### Hot Meals

- Six (6) hot meals available before show:
  - Hot meals should have meat/fish, vegetable, starch, bread, and dessert.
- Tea and coffee service
- Variety of cold drinks and water
- Napkins, flatware, cups
- No alcohol
- Times should be coordinated with Artistic Director

Initials \_\_\_\_\_

Purchaser agrees to provide Hot Meals as detailed above.

### Amenities

- six (6) hand towels off stage
- six (6) bottles of still water on stage

Initials \_\_\_\_\_

Purchaser agrees to provide Amenities as detailed above.

### Contact Information

Camarada:

Title	Name	Phone Number	Email Address
Artistic Director	Beth Ross Buckley	619.917.2444	bethrossbuckley@gmail.com
Agent	Marian Liebowitz	619-988-0751	marian@marianliebowitz.com

Purchaser:

First and Last Name \*

Title \*

Phone Number \*

Email Address \*

Purchaser:

I agree to the terms and conditions of this contract.

First Name \_\_\_\_\_

Last Name \_\_\_\_\_

*Signature*

Artist:

I agree to the terms and conditions of this contract.

First Name \_\_\_\_\_

Last Name \_\_\_\_\_

*Signature*

---